

**Technical Specifications NOISEREDUCER SINGLE ABSORPTION SA-80\_A5**

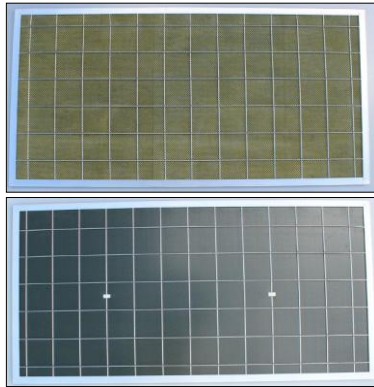

Noiseside:  
Mineral wool and  
nettings  
  
Backside: coated  
steel plate

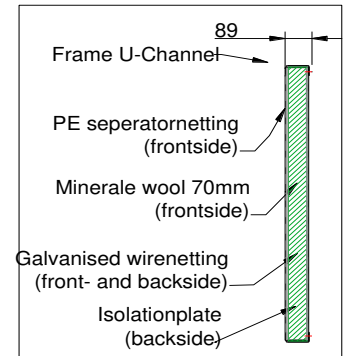

**Dimensions and pattern NOISEREDUCER® SA-80 Noise Barrier-A5:**

- Standard pattern (HEA upright):  $W_{\text{pattern, standard HEA}} = \text{panelwidth: } 3.960\text{mm (hoh. } 4.000\text{mm)}$ .
- Any other size smaller than 3,96 can be supplied
- Maximum height:  $h_{\text{max}} = 7,7 \text{ metres starting from ground level (5 stacked panels)}$
- Maximum panel Height:  $h_{\text{panel, max.}} = 1,50\text{m}$

**Steel Construction, HEA or IPE uprights:**

*Style of Foundation column:*

- Taking into account the barrier's height, windload and soil conditions as from HEA120 up to IPE300 (or HEA240) are applicable – S235 hot-dip galvanised EN ISO 1461, DIN 17100 quality standard. Headplate d=20-25mm with slots for bolts.

*Style of upright:*

- Taking into account the barrier's height, as from HEA120 up to IPE300 (or HEA240) are applicable – S235 hot-dip galvanised EN ISO 1461, DIN 17100 quality standard., with pre drilled mounting holes, diameter 8 mm, Optional powder coating in any desired colour., Footplate d=15-25mm with 90° slots for bolts.
- Optionally two layer powder coated in any desired standard RAL colour (additional cost)

**Panels: NOISEREDUCER® SA-80 Noisebarrier**

- Framework made of cold-rolled U-80-50-3, profile S235, hot-dip galvanised EN ISO 1461, quality standard DIN 17100.
- Frame and/or wirenetting optionally powder coated in any desired standard RAL colour (additional cost)
- Sound insulation, single number descriptor reading - NEN-EN-ISO-717-1: **Rw= 30dB(a)** - EN 1793-2, Category B3 ( $D_{\text{ra}} > 25\text{dB}$ ). Please see attachment TNO Sound Insulation reading.
- Sound Absorption, single number descriptor reading - NEN-EN-ISO-717-1: **D<sub>ra</sub>= 17dB(a)** - EN 1793-1, Category A5 . Please see attachment Peutz Sound Absorption reading..
- Front side: a layer of 70mm mineral wool, covered with a layer of PE separator mesh 5mm, colour dark green RAL6007 or anthracite grey RAL7016.
- At the backside a plastisol coats steelplate 0,75mm, colour darkgreen RAL6007 or antracitgrey RAI7016 (20 other colours are available)
- Optional extra HDPE windsheet 180gr/m2 between PE separator netting and wirenetting in matching colour (additional cost)
- Front- and backside: a 6mm galvanized wire netting mesh 15 x 15cm
- Mass of panels: 24–33kg/m<sup>2</sup> depending on size

*Dimensions panels: Standard HEA*

Standard width panel :	$W_{\text{panel, stand}}$	= 2.960 or 3.960
Allowable placement tolerance:	$T_{\text{pl, panel}}$	= 40mm (in relation to $w_{\text{pattern}}$ )
Maximum height panel:	$h_{\text{panel, max}}$	= 1.500 mm

**Concrete gravelboard:**

- Positioned under the panels for support and used for limited slopes. Enforced with 4 x concrete iron wire Ø8mm
- Standard Gravelboard 2.960 or 3.960 x 190 x 90mm (can easily be cut with a grinder to desirable size)

**Joint materials:**

- Attachment panels, per item: 8 x self-tapping hexagon shoulder pin ST.6,3 x 38 mm - DIN 7405K
- Attachment uprights, per item:  
4 x Bolt / Washer and Nut M16-M30 x 90 hexagon head hot dip galvanised, DIN 933 Quality 8.8

**Synthetic material:**

- PE separator netting 2mm, perforation 5mm, UV stabilized, color darkgreen RAL6007 or antracitgrey RAL7016.
- HDPE windsheet 180gr/m2 in matching colour between PE separator netting and wirenetting, color darkgreen RAL6007 or antracitgrey RAL7016
- Compriband 15mm self-adhesive cellular rubber, between stacked panels.

[Geef tekst op]